

# Technical data sheet

## Product features



### Bain marie mobile cabinet long

<b>Model</b>	<b>SAP Code</b>	00019511
--------------	-----------------	----------



- Device properties: Warmed
- GN / EN size in device: GN 1/1
- GN device depth: 200
- Minimum device temperature [°C]: 30
- Maximum device temperature [°C]: 90

<b>SAP Code</b>	00019511	<b>Loading</b>	230 V / 1N - 50 Hz
<b>Net Width [mm]</b>	1250	<b>GN / EN size in device</b>	GN 1/1
<b>Net Depth [mm]</b>	700	<b>GN device depth</b>	200
<b>Net Height [mm]</b>	900	<b>Minimum device temperature [°C]</b>	30
<b>Net Weight [kg]</b>	88.00	<b>Maximum device temperature [°C]</b>	90
<b>Power electric [kW]</b>	2.100		

# Technical data sheet

Technical drawing



## Bain marie mobile cabinet long

Model

SAP Code

00019511

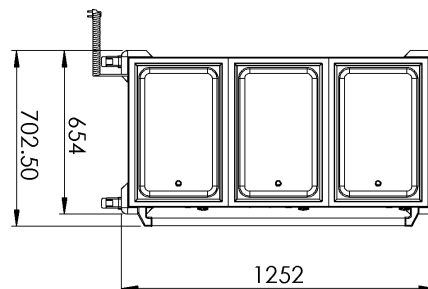
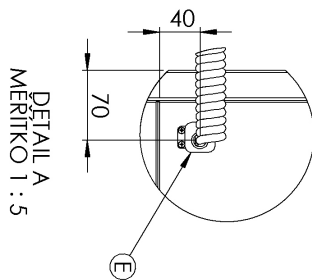
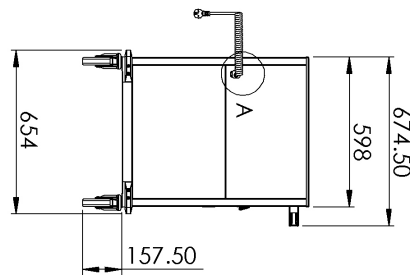
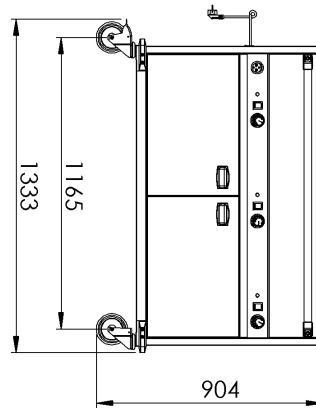

# Technical data sheet

Technical parameters



## Bain marie mobile cabinet long

Model

SAP Code

00019511

### 1. SAP Code:

00019511

### 2. Net Width [mm]:

1250

### 3. Net Depth [mm]:

700

### 4. Net Height [mm]:

900

### 5. Net Weight [kg]:

88.00

### 6. Gross Width [mm]:

1300

### 7. Gross depth [mm]:

730

### 8. Gross Height [mm]:

920

### 9. Gross Weight [kg]:

95.00

### 10. Device type:

Electric unit

### 11. Material:

AISI 304 top plate, AISI 430 cladding

### 12. Device properties:

Warmed

### 13. Exterior color of the device:

Stainless steel

### 14. Power electric [kW]:

2.100

### 15. Loading:

230 V / 1N - 50 Hz

### 16. GN / EN size in device:

GN 1/1

### 17. GN device depth:

200

### 18. Minimum device temperature [°C]:

30

### 19. Maximum device temperature [°C]:

90